

## MS2-TB3 快速安裝導引

### 產品示意圖與配件表

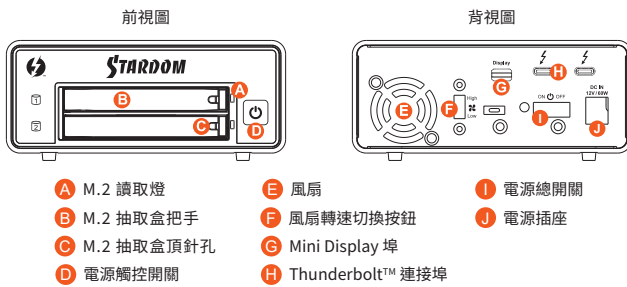

打開包裝外盒後，包裝內容應包含下列組件：

#### 產品配件表

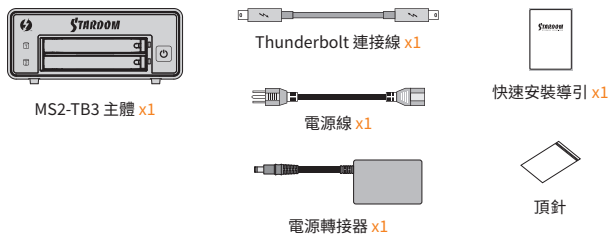

- 請先確認相關配件與產品本身是否有受損或是缺少配件，若有任何疑問，請與您的經銷商或業務人員聯絡。
- 請前往官網 ([www.stardom.com.tw](http://www.stardom.com.tw)) 下載使用者說明書。

注意：開啟產品電源前，請確認產品與主機端（開機狀態）已連接，否則產品將進入休眠狀態。



1

V1.0 (Feb. 2020)

### 燈號說明

狀態	M.2 讀取燈
無 M.2	OFF
資料存取	藍燈恆亮
M.2 閒置	藍燈恆亮

提醒：

燈號顯示會因 M.2 廠商的定義不同而有所差異。

### 硬體安裝

請參照下列步驟，完成 MS2-TB3 的硬體安裝：

- 將系統擺放於穩固平台，並確認散熱風扇口沒有被其他物體擋住，系統四周有適當的散熱空間。（擺放環境請避免接近潮濕或其他易對產品造成損傷的環境）
- 使用配件中所附的頂針插入 M.2 抽取盒頂針孔，抽取盒把手將會輕彈開啟。

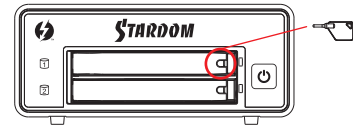

- 取出抽取盒上蓋的螺絲，再用頂針撬開上蓋並移除。

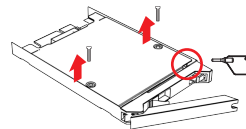

- 取出固定 M.2 位置的螺絲。

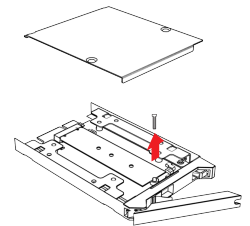

- 插入 M.2 並鎖上螺絲。

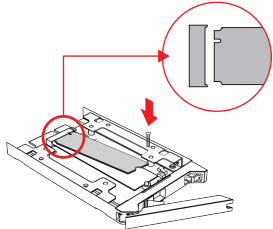

- 撕下上蓋裡散熱片的離型紙，蓋回上蓋。

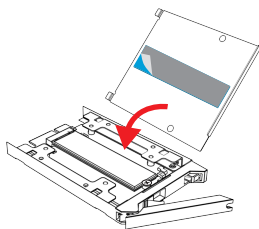

- 鎖上螺絲。

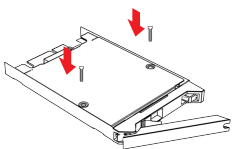

- M.2 安裝完成後，請將抽取盒平移放入主機內，並關上把手。

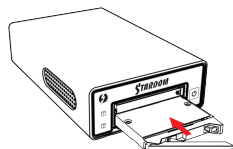

- 將相關連接線接上，最後接上電源轉接器。
- 先將產品背面的電源總開關扳動至「I」讓電源開啟，再輕壓產品正面的電源觸控開關，直到電源符號「O」燈號熄滅；若要使用產品則輕壓產品正面的電源觸控開關，直到電源符號「O」燈號發亮。
- 若暫時不使用產品，可讓產品進入關機模式：先輕壓產品正面的電源觸控開關，直到電源符號「O」燈號熄滅；若要使用產品則輕壓產品正面的電源觸控開關，直到電源符號「O」燈號發亮。
- 假使長時間不使用產品，則請將產品電源總開關關閉：先輕壓產品正面的電源觸控開關，直到電源符號「O」燈號熄滅，再將產品背面的電源總開關扳動至「O」讓電源關閉。

※ 本產品在關機模式下為接近完全斷電的狀態，硬碟、LCD 與風扇均停止運作，僅提供一小部分電力為之後啟動作準備。

3

### 產品使用注意事項

- 本系統同一時間只可透過一組介面與一台電腦執行資料傳輸。
- M.2 格式化後的可使用儲存容量會小於 M.2 標示的容量。
- 第一次使用本產品進行設定時，資料會被全數清除。請於硬碟置入前，確認 M.2 已備份，避免資料遺失。
- 當您需要關閉或移除 MS2-TB3 時，務必透過您所操作的作業系統中執行安全移除後，方可進行電源關閉的動作。
- MS2-TB3 使用 12V/5A 規格 Adapter，請勿使用其他非原廠規格 Adapter 以免損壞機器及資料。
- 本產品不支援 M.2 熱插拔功能，若需取出抽取盒，請在關閉電源總開關的狀態進行，避免軟硬體損毀。
- 強烈建議除了使用 MS2-TB3 的資料儲存功能外，請針對重要資料備份到另一個儲存裝置上或雲端備份，雙重備份您重要的資料。若您儲存在 MS2-TB3 的資料損毀或遺失，STARDOM 將不負任何的責任。

感謝您使用 銳銳科技股份有限公司 的產品。

本手冊裡的資訊在出版前雖然已經被詳細確認，但實際產品規格將已出貨時為準；任何的產品規格或相關資訊更新，請您直接上 [www.STARDOM.com.tw](http://www.STARDOM.com.tw) 網站查詢，或直接與您的業務聯絡窗口聯繫，本公司將不另行通知。

如果您對 銳銳科技 的產品有任何疑問，或是想獲得最新產品訊息、使用手冊或軟體，請您聯絡 [services@stardom.com.tw](mailto:services@stardom.com.tw)，我們將儘速回覆您。

本說明相關產品內容歸 銳銳科技股份有限公司 版權所有

4

## MS2-TB3 Quick Installation Guide

### Product Diagram & the Contents of Product package

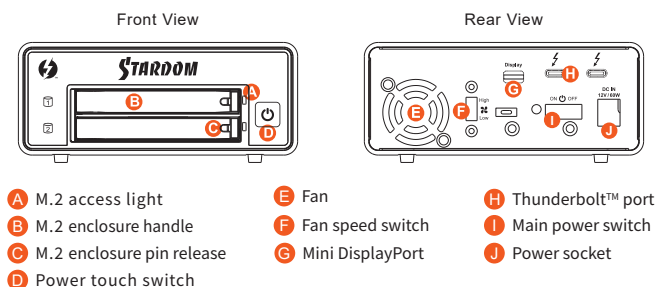

The following items should be inside the package upon opening:

#### Contents of Product Package

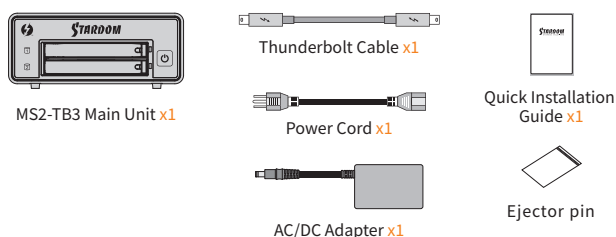

- Please check the included parts and the product itself for any damage or missing parts. If you have any questions, please contact the retailer or sales representative.
- Please download the user manual from the official website ([www.stardom.com.tw](http://www.stardom.com.tw))

**NOTE:**  
Please make sure that the product is connected to the host (power on status) before turning on the power, otherwise the product will be on the sleep mode.



1

V1.0 (Feb. 2020)

### the Indication of M.2 Status

Status	M.2 access light
No M.2	OFF
Data access	Blue light always on
M.2 idle	Blue light always on

**Remind:**  
Signal display will vary depending on the definition of M.2 manufacturers.

### Hardware Installation

Please follow the following procedure to have your MS2-TB3 installed:

- Place the system on a stable surface. Ensure that the vent is not blocked and that it is installed in a well-ventilated area. (Please keep the product away from moisture and other environment that might be harmful to the product)
- Use the ejector pin included in the accessory kit to eject the M.2 enclosure handle, and then pull tray handle to remove it.

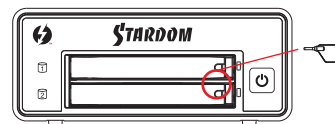

- Remove the screws of the upper cover of the tray, and then use the ejector pin to pry open the upper cover and remove it.

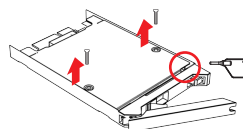

- Remove the screws holding the M.2 position.

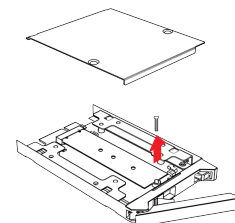

- Insert M.2 and lock the screws.

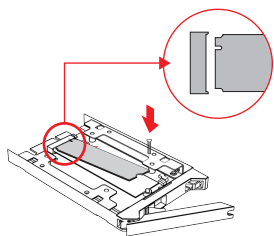

- Remove the release paper from the heat sink in the upper cover and replace the upper cover.

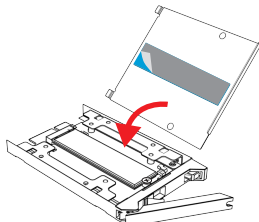

- Lock the screws.

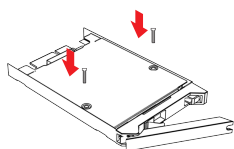

- When the M.2 installation has been completed, insert the tray into the system horizontally and secure the latch into place.

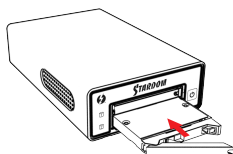

- Please connect the signal cable first, and then power cord later.
- First turn **the main power switch on the back of the product** to "I" to turn the power on, then gently press **the touch power on the front of the product** until the power symbol "O" lights up.
- After turning on the power, please perform subsequent formatting settings through the operating system. Please follow the instructions of the computer operating system for M.2 formatting; after formatting, you can read and write data.
- If you are not using the product for a while, you can put the product into shutdown mode: first press **the touch power on the front of the product** until the power symbol "O" is off; if you want to use the product, gently press **the touch power on the front of the product** until the power is turned on. The symbol "O" is illuminated.
- If the product is not used for a long time, please turn off the product main power switch: first gently press **the touch power on the front of the product** until the power symbol "O" is off, then turn **the main power switch on the back of the product** to "O" to turn off the power.

※ The product is in a state of near-complete power-off in shutdown mode, and the hard disk, LCD, and fan are all out of operation, providing only a small portion of power for preparation for subsequent startup.

3

### Important Notice

- This system can only transfer data to one computer through one interface at a time.
- The usable storage capacity of the M.2 after formatting will be less than the capacity indicated on the M.2.
- All existing data will be deleted when this product is set up for the first time. Please ensure that all data on the M.2 has been backed up before installation to avoid data loss.
- If the MR2-TB3 needs to be shut down or disconnected, please ensure the MR2-TB3 is safely removed through your operating system before turning off the power.
- MS2-TB3 uses a 12V/5V AC/DC Adapter. Please do not use other non-certified Power Adapter to avoid damaging to your MS2-TB3.
- This product does not support the M.2 hot-swap function. If you need to remove the tray, please do it with the main power switch off to avoid damage to software and hardware.**
- We strongly recommend backing up important data stored on the MS2-TB3 to another storage device or a remote site. STARDOM will not be held liable for the damage or loss of data you stored on the MS2-TB3.

Thank you for choosing product from **RAIDON Technology Inc.** This information in the manual has been thoroughly checked before publication, but may not conform to the product actually delivered which mean actual product specifications depend on the product shipped to you. Any update in the specifications or product-related information shall not be subject to further notice but for the latest information on the product, please visit the website as [www.STARDOM.com.tw](http://www.STARDOM.com.tw) or contact us at [services@stardom.com.tw](mailto:services@stardom.com.tw), and we will get back to you as soon as possible.

Copyright © RAIDON TECHNOLOGY, INC. All rights reserve

4